

# National Society of Black Engineers Region Six

Regional Leadership Conference  
PROGRAMS BOOK 2004

THE DOCUMENT COMPANY  
**XEROX**



NSBE's mission is to increase the number of culturally responsible Black engineers who excel academically, succeed professionally and positively impact the community.

AUGUST 6TH-8TH, 2004

SAN DIEGO, CA

Greetings Family!

It is with great excitement that I welcome you to the first regional event of the academic year, the Regional Leadership Conference. I would first like to commend you for taking on your respective leadership roles and thank you for continuing to make NSBE Region 6 an outstanding place for young black technical professionals to grow, learn & make a positive impact in our communities. It is your "Commitment to Excellence" that will take us full speed into this new NSBE year and make it one of the best that this organization has ever seen.

This year will be one of regrouping and focusing on the core principles of this organization. It is also a time to bring the various members of our Region 6 Family back together, so that we may all work together in achieving our individual goals. Your new Regional Executive Board (REB) is an amazing group of young leaders who have come together with one objective in mind. We have worked endless hours in:

Refueling the Membership

Reviving the Tradition

"Reuniting the Region 6 Family"

It is the priority of your new REB and the Conference Planning Committee (CPC) of this conference to ensure that you all leave San Diego this weekend with a firm understanding of how to lead your respective chapters. Now is the time to pay attention, ask questions and speak your mind. We are here to help you, the membership of Region 6, fulfill the mission statement and become successful. So please, don't take this opportunity lightly. Make use all of the resources that will be made available to you this weekend.

I am truly looking forward to working with you all this year and I am extremely excited about the upcoming year. I know that my family will become a stronger, more cohesive unit than ever before, working together to excel academically, succeed professionally and positively impact the community. So this weekend remember to work hard, play hard and don't forget the SIX HUGS!

SIXcerely,

Syreeta A. Thomas

Region 6 Chairperson 2004-2005



## Conference Planning Committee

|                           |                             |
|---------------------------|-----------------------------|
| <b>Kederra McDaniel</b>   | <b>CPC Chair</b>            |
| <b>Clayton Jordan III</b> | <b>PDC Chair</b>            |
| <b>Nia Price</b>          | <b>Speakers/Workshops</b>   |
| <b>Jermaine Walker</b>    | <b>Transportation</b>       |
| <b>Miah Simms</b>         | <b>Registration Manager</b> |
| <b>Joseph Robinson</b>    | <b>Entertainment</b>        |
| <b>Dominique Ralph</b>    | <b>Webmaster</b>            |
| <b>Basil Etefia</b>       | <b>Publications</b>         |



## SPONSOR THANK YOU

On behalf of the National Society of Black Engineers Region VI Leadership, we would like to thank PG&E, BAE Systems, Hewlett-Packard Company (San Diego Site), 3M, Qualcomm, UPS, Northrop Grumman, Deloitte & Touche and Xerox for supporting RLC as well as their continued commitment in helping establish the NSBE Mission and Vision.

Greetings NSBE Alumni Leaders,

My name is Clayton Jordan, III and I am the Region VI Alumni Conference Planning Manager. I would like to welcome every one of you to San Diego and to the Regional Leadership Conference, "A Commitment to Excellence". Hopefully, you can gage from the conference theme that we expect the NSBE Leadership to take our organization to the next level, in part through your commitment to excellence. Regardless to where we may have ended last year, we must build upon and critically access our experiences then implement" best practices" just as we are expected to do in our careers. "A Commitment to Excellence" is applicable in every aspect of life. The skills and techniques are no different and can easily be applied to the NSBE Corporation.

You can anticipate a weekend filled with education, enlightenment, and the exchanging of ideas, concepts, processes, procedures, methodologies, techniques, and many more things that will not only enhance your NSBE Leadership Experience, your individual chapter's success, but also will enhance your personal and professional goals and objectives. Please understand that the commonly used proverb will stand this weekend. That is, at minimum, you can only get out (of NSBE) what you put in. The exciting thing about applying this proverb to the NSBE Formula is that if the right variables are controlled, you will get much more out (of NSBE) than you put it. It will then be your responsibility to share the experience and learning with others within the NSBE family, especially NSBE Junior and Collegiate as well as outside the walls of NSBE. You will be exposed to the tools, what will you do with them?

I look forward to meeting each and everyone one of you during the course of the weekend. Please remember the ultimate reason we choose to be members of NSBE. That is to increase the number of culturally responsible black engineers, who excel academically, succeed professionally, and positively impact the community! Have a blessed weekend!

With much NSBE Luv,  
cj3

**Clayton Jordan, III**  
**Conference Planning Manager**  
[r6aeconfmgr@nsbe-ac.org](mailto:r6aeconfmgr@nsbe-ac.org)

National Society of Black Engineers - Region VI Alumni Extension  
[www.nsbe-ac.org/region6](http://www.nsbe-ac.org/region6)  
[www.nsbe-ac.org](http://www.nsbe-ac.org)



Dear Region 6 Family,

I would like to welcome everyone to the 2004 Regional Leadership Conference. This year's theme, "A Commitment to Excellence", reflects exactly what your Regional Alumni Extension Board has in store for you. The RAEB has been hard at work to provide a successful conference for our current chapter leaders and potential chapter and regional leaders.

Your RAEB's primary goal is to ensure that the current needs of the Alumni are met. This year, we have aimed at adding value to your membership within the Alumni Extension. Our key focus areas include: Communications, Programming, Finances, and Leadership training.

Our first order of business is leadership training for our chapter executives. Our reasoning behind this weekend is to make certain that chapters are equipped to effectively serve their chapter members as well as their local communities. Although, training doesn't end with RLC, my hope is that enough information is provided to ensure that our Alumni chapters are built upon strong foundations. The value in attending RLC will not only benefit your chapter members but also your personal and professional interests.

In closing, your RLC experience promises to be one filled with opportunities for fundamental training, overall leadership development, and fellowship within the Black Engineering/Professional Community. Over the next two days, you will have access to your regional officers and fellow chapter executives. For that reason, I encourage you to interact with your regional, collegiate, and alumni chapter counterparts.

I'm eager to meet everyone this weekend. I thank you for your time and look forward to serving you this year.

Respectfully,  
Latesha Young  
Region 6 Alumni Executive Board Chair 2004-2005



# Agenda

Friday, August 6th, 2004

-Collegiate   -Alumni   -Alumni/Collegiate   -RAB Meeting   -All

| Time               | Event                      | Location                                | Facilitator   |
|--------------------|----------------------------|---|---------------|
| 12:00 P.M.         | REB, RAEB, and CPC Arrival | TBA                                     | N/A           |
| 1:00pm-2:30pm      | REB and RAEB Meeting       | Olmeca Class Room                       | N/A           |
| 3:00pm-4:00pm      | RAEB Meeting               | Maya Class Room                         | N/A           |
| 3:00pm-5:45pm      | REGISTRATION               | TBA                                     | N/A           |
| 6:00pm-7:30pm      | OPENING SESSION            | Cuicacali                               | REB           |
| 7:30pm-8:30pm      | DINNER- <i>On Your Own</i> | N/A                                     | N/A           |
| 7:45pm-10:00pm     | First Friday's Mixer       | 504 Gallery 3041 University, San Diego, | N/A           |
| 8:45pm-10:45pm     | NSBE 101: Zone Wars        | TBA                                     | Programs Zone |
| 10:00 pm -11:30 pm | NSBE-AE 101                | Off-Site                                | RAEB          |
| 11:00pm-Until      | ENTERTAINMENT              | TBA                                     | N/A           |



## Conference Center Map Locations

- Map Location #6 - Council Chambers
- Map Location #8 - Montezuma Hall
- Map Location #11 - Presidential Suite
- Map Location #11 - Quetzalcoatl A
- Map Location #11 - Quetzalcoatl B



# Conference Center Map II

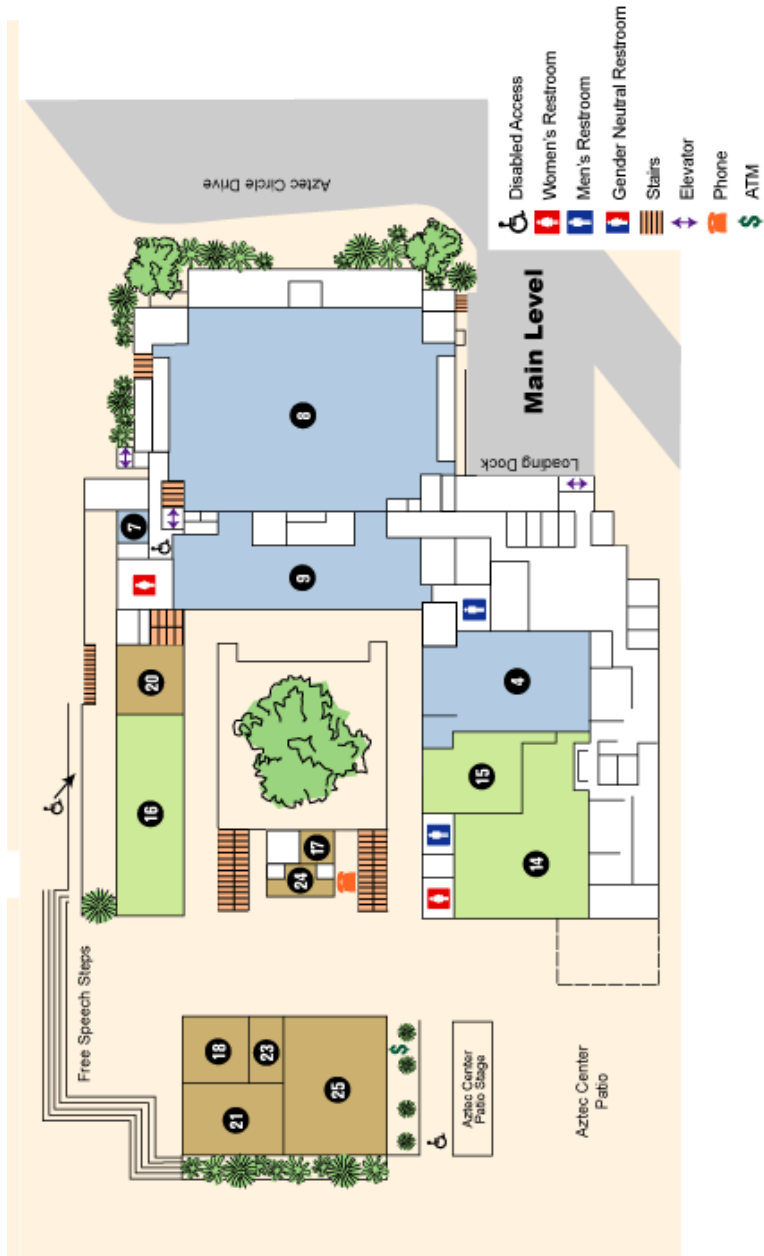

## Agenda

Saturday August 7th, 2004

-Collegiate -Alumni -Alumni/Collegiate -RAB Meeting -All

| Time   | Event                               | Location                    | Facilitator                           |
|--|-------------------------------------|-----------------------------|---------------------------------------|
| 7:00am-8:00am  | REGISTRATION                        | TBA                         | N/A                                   |
| 7:am-7:45am  | BREAKFAST-Badge Required            | Montezuma Hall              | N/A                                   |
| 8:00am-10:00am   | GENERAL SESSION I                   | Montezuma Hall              | REB                                   |
| 12:00pm-4:00pm   | Programs Lounge                     | Casa Real                   | TBA                                   |
| MODULE 1 - CHAPTER OFFICER FUNCTIONAL TRAINING           |                                     |                             |                                       |
| 10:10am -12:15pm   | Chapter Officer Functional Training | Check Workshop Descriptions | RAEB                                  |
| 10:10am-11:30am  | MODULE 1 - FUNCTIONAL TRAINING      | Check Workshop Descriptions | REB                                   |
| 12:35pm -1:35pm  | LUNCH                               | Cuicacali Dining Hall       | N/A                                   |
| 11:35am - 12:35pm  | MODULE 2 - SKILL DEVELOPMENT        | Check Workshop Descriptions | REB                                   |
| Collegiate/Alumni Relations—MODULE 2 - Skill Enhancement |                                     |                             |                                       |
| 1:45pm-3:00pm  | Leadership Management               | Check Workshop Descriptions | Ann Phillips, Ken Blanchard Companies |
| 3:10pm-4:15pm  | Making NSBE Effective               | Check Workshop Descriptions | RAEB                                  |
| 4:15pm-4:30pm  | Break                               | N/A                         | N/A                                   |



# Agenda

Saturday August 7th, 2004

- Collegiate   - Alumni   - Alumni/Collegiate   - RAB Meeting   - All

| Time                        | Event                        | Location                    | Facilitator                          |
|-----------------------------|------------------------------|-----------------------------|--------------------------------------|
| 1:45pm - 2:45pm             | MODULE 3 - PRO-GRAMMATIC     | Check Workshop Descriptions | REB                                  |
| Zone Meetings               |                              |                             |                                      |
| 3:00pm-4:00pm               | Zone 1, 2, 3 & 5             | Chantico                    | Zone Leaders                         |
| 3:00pm-4:00pm               | Zone 6-9                     | Calmecac                    | Zone Leaders                         |
| 3:00pm-4:00pm               | Zone 4, 10                   | Council Chambers            | Zone Leaders                         |
| 4:00pm-4:30pm               | BREAK/CEB Meeting            | N/A                         | N/A                                  |
| 4:00pm-5:00pm               | RAB Meeting                  | Aztlan                      | RAB Chair                            |
| 4:30pm-5:00pm               | NSBE Certification Exam      | Montezuma Hall              | REB                                  |
| 5:15pm-6-15pm               | DINNER- BBQ                  | Cuicacali Pool Area         | San Diego Alumni Extension           |
| 6:30pm-8-30pm               | GENERAL SESSION II           | Montezuma Hall              | REB                                  |
| MODULE 3 - Team Building    |                              |                             |                                      |
| 6:45pm -8:45pm              | The More You Know            | Presidential Suite          | Ebube Akosionu & Clayton Jordan, III |
| MODULE 4 - Team Building II |                              |                             |                                      |
| 9:00pm -10:30pm             | Alumni Chapter Board Meeting | Presidential Suite          | RAEB                                 |
| 10:30pm-Until               | ENTERTAINMENT - Lets Party   | Tula Hall                   | N/A                                  |



## Conference Center Map Locations

Map Location #1 - Aztlan

Map Location #2 - Backdoor

Map Location #3 - Calmecac

Map Location #4 - Casa Real

Map Location #5 - Chantico



# Conference Center Map I

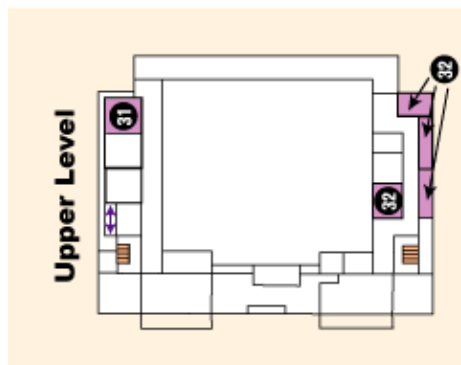
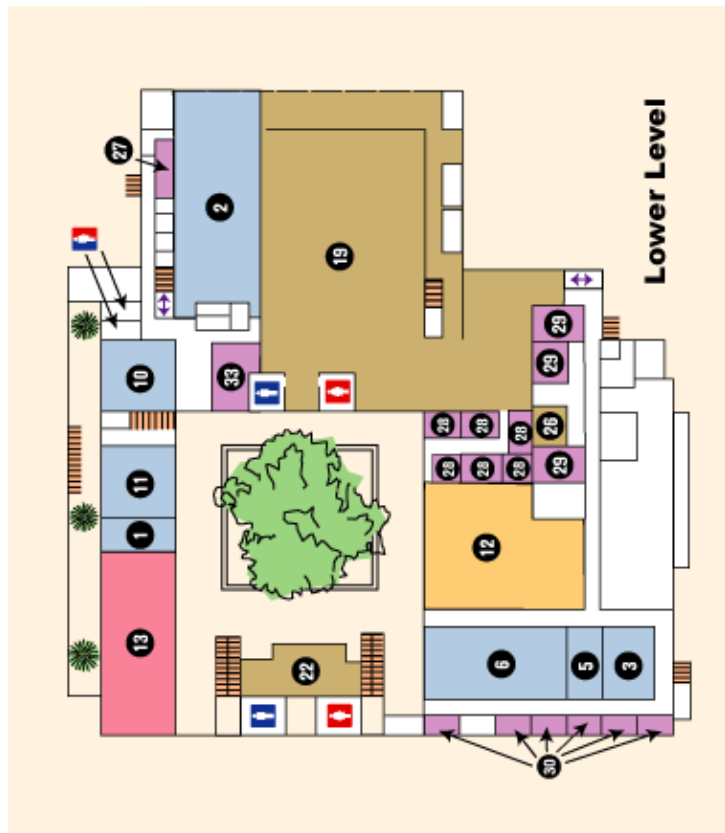

- Disabled Access
- Women's Restroom
- Men's Restroom
- Gender Neutral Restroom
- Stairs
- Elevator
- Phone
- ATM

## Agenda

Sunday, August 8th, 2004

- Collegiate    - Alumni    - Alumni/Collegiate    - RAB Meeting    - All

| Time                   | Event                       | Location  | Facilitator |
|------------------------|-----------------------------|---|-------------|
| 7:30am-8:00am          | BREAKFAST-Continental       | Tula Hall   | TBA         |
| 7:30am-8:00am          | NSBE Certification Re-take  | Tula Hall   | REB         |
| 8:00am-8:30am          | NSBE Certification Re-take  | Tula Hall   | RAEB        |
| Functional Zone Forums |                             |   |             |
| 8:15am-9:45am          | Presidents                  | TBA   | REB         |
| 8:15am-9:45am          | Vice-Presidents             | TBA   | REB         |
| 8:15am-9:45am          | Communications              | TBA   | REB         |
| 8:15am-9:45am          | Finance Zone                | TBA   | REB         |
| 8:15am-9:45am          | Programs Zone               | TBA   | REB         |
| 8:45am-9:45am          | Tool Time                   | TBA   | RAEB        |
| 10:00am-12:00pm        | CLOSING SESSION             | Tula Hall   | TBA         |
| 12:00pm-1:00pm         | CHECKOUT                    |   |             |
| 12:45pm-2:45pm         | Alumni Brunch               | Monroe's Café<br>7404 University Ave, La Mesa, CA | On Your Own |
| 3:00pm-until           | DEPARTURE-Thanks for coming |   |             |



# Workshop Descriptions

## Module 1: Functional Training

### Presidents/Vice-Presidents Functional

Quetzalcoatl A

As the newly elected Chapter President or V.P. what should you do to effectively lead your chapter? This workshop will give you the tools for you to manage your chapter successfully. In this workshop, we will discuss your roles & responsibility, effective, strategic planning, efficient use of campus resources, successful professional & academic relations, board management, why monthly reports are important, and programs/awards.

**Facilitators:** Leah Turner, Zawan Parker

### Communications Zone Functional

Quetzalcoatl B

This workshop is designed for secretaries, telecommunications chairs, publications, and public relations chairs. In this workshop, NSBE leaders will learn how to keep their chapter communicating effectively, highly publicized, and well organized.

**Facilitators:** Dominique Ralph, Candace Vaughn

### Finance Zone Functional

Calmeac

This workshop will cover all the responsibilities, fundamentals, and expectations associated with chapter finance zones. The responsibilities of Chapter Treasurers and Finance Chairs will be clearly outlined and explained in detail. Information such as chapter relief, tax exemption, monthly reports, NSBE financial procedures, and tips to successfully manage the finances year will also be covered.

**Facilitators:** Jason Owens, Kamilah White

### Programs Zone Functional

Presidential Suite

Rather than reinventing the wheel, the Programs Zone will be re-implementing a number of programs that have been known to be successful in the past. Since programs can draw members in, the focus will be increasing membership by increasing interest in NSBE through activities. For the over-achieving student, and for the one who desires very little leadership initiative, there is an individual aspect of NSBE that need not be forgotten. The information provided is designed to help each chapter create a foundation to be a constant example of the mission statement.

**Facilitators:** Tiffini Buchanan, Joel Townsend, Lanita Williams, Angela Thompson

### Senators Functional

Chantico

This will be the first training session for chapter senators, so that they will become familiar with their role in NSBE. Expectations and parliamentary procedure will be covered as well as an introduction to some of the important topics that may become issues within the NSBE Senate in the upcoming year.

**Facilitators:** Kim Cross



Welcome Region 6 leaders,

I look forward to serving Region 6 as the 2004-05 RLC Chairperson and I am excited about what this upcoming year will do for me as a leader in the future. Your plans to attend RLC on the campus of beautiful San Diego State University couldn't have made me happier. San Diego has more to offer than beautiful weather, beaches, and palm trees. It provides the setting to what is being projected as one of the best Region 6 Regional Leadership Conferences in many years.

The Conference Planning Committee and the REB are committed to ensuring that you will receive the training and skills that will stay with you throughout your college and professional careers. A quote I live by everyday, "Success is measured through progress," – Kederra L. McDaniel II, has strengthened me in playing my part in preparing you for future success. This year we are committed to making progress; to cultural responsibility; to excelling academically; to succeeding professionally and to making an impact in our community. When committing everything you have to offer, you are stating your, "Commitment to Excellence."

When it comes to NSBE leadership, Region 6 has been known to be second to none when it comes to conference preparation. From the entertainment to the training and workshops, to the linen sheets you snuggle under, we have considered what will bring out the best in you all.

On behalf of the CPC and REB, I thank you for joining us for this years' theme, "Commitment to Excellence." I encourage you take from this conference all that it has to offer as I know the strength of the foundation laid for you will weather any storm you may encounter, both in your professional and personal lives.

Six Luv,

Kederra L. McDaniel II  
04-05 Regional Leadership Conference Chair



## Speaker Bio



**E. Ann Phillips**  
Consultant, Speaker, and Trainer

Ann Phillips is a gifted facilitator and highly skilled consultant. With more than 20 years of diverse business experience, combined with knowledge, enthusiasm, and an understanding of organizational dynamics, Ann has initiated powerful positive changes in numerous organizations.

Ann's experience in staff and skills development has helped her in designing and delivering dozens of leadership, career-development, and organizational-change processes to a broad array of audiences. She is also an experienced facilitator of Situational Leadership® II, Situational Self Leadership, Building High Performing Teams®, and Raving Fans®.

Before joining The Ken Blanchard Companies, Ann's career focus was on nonprofit organization development, where she gained experience not only in the United States but abroad in Ghana and Kenya as a consultant to senior management and program staff. Ann is a graduate of the University of Pacific with a degree in recreational administration. She also holds a master's degree in management with an emphasis in organizational change and transformation.

Ann has recently worked with Broward County Schools, City of Sacramento, Customer Data Corporation, General Motors, Miami-Dade Community College District, Nonprofit Development Center, State of Tennessee, The Board Connection, United Auto Workers, YMCA.

*"Ann Phillips is an outstanding instructor and made the material fun and interesting, which is rarely found these days in a day-long training program." — Kristin Suyers-Hoop, M.A. The Permanente Medical Group, Inc.*

*"What a successful training! The participants liked your energy, enthusiasm, humor, and handouts." — Maria Ruiz, Nonprofit Development Center*

*"Ann, you were such a success! You received rave reviews! We will definitely be in touch for future events! Your conscientious planning and concern for presenting a beneficial workshop are very much appreciated. Thanks for doing such a good job." — Beverly Tate, Miami-Dade Community College*



## Workshop Descriptions

### Module 2: Skill Development

#### Parliamentary Procedure

Location

This introduction to parliamentary procedure will simplify all the rules and procedures needed to successfully participate in a meeting where parliamentary procedure is being used.

**Facilitators: Kim Cross**

#### Leadership & Management Skills for the NSBE Officer

Council Chambers

This interactive workshop will explore the differences between leadership & management skills and how to apply both skill sets to your role as an officer in NSBE. Topics of discussion include goal setting, teamwork, planning and delegation.

**Facilitators: Syreeta Thomas**

#### Keeping Your Membership Motivated – NSBE Buy-In

Presidential Suite

One of the biggest problems faced by chapters is keeping members motivated and working for NSBE all year. This workshop will provide advice on how to keep your membership HYPED about NSBE and ready to stay involved.

**Facilitators: Angela Thompson & Tiffini Buchanan**

#### Public Speaking/Presentation Skills

Quezalcoat B

Public Speaking can be very terrifying to some people. This workshop will not only teach you how to give a presentation correctly, but also help you relax your nerves as you present.

**Facilitators: TBA**

#### Academic Excellence & Time Management

Chantico

Half of the workshop will be on time management and how to be a leader, a student, a business person, and an engineer without killing yourself; the healthy timed lifestyle of a NSBE leader. The second half of the workshop will be like an open forum discussion. I will talk about the importance of Academic Excellence this year since it is a National Directive, the programs that will be implemented this year, the competitions that will go on at FRC, and how they feel we can improve the Academic Excellence of the programs zone.

**Facilitators: Lanita Williams**



## Workshop Descriptions

### Module 3: Programmatic

#### Chapter Development Workshop

Quetzalcoatl A

The objective of the Chapter Development Program is to strengthen the backbone of chapters by achieving the objectives and goals of the National Long Range Plan and documentation of chapter's yearly activities as a means of measuring chapter progress. Involvement in the CDP will maximize each chapter's development through active participation in NSBE Programs and Activities. It is a chance to showcase the chapter's programmatic activities and to set a standard of chapter excellence of its membership while it assists chapters in the complete development of their membership recognition. The workshop will assist leaders in documenting the activities related to the CDP and will also discuss the benefits of completion.

**Facilitators: Leah Turner, Zawan Parker, Tiffani Buchanan**

#### Collegiate/Alumni Relations

Chantico

Collegiate chapters and alumni chapters fulfill the same NSBE mission, just have different target audiences. This workshop is to educate NSBE members on how to develop working relationships between local collegiate and alumni chapters.

**Facilitators: Syreeta Thomas, Lanita Williams**

#### Financing/Fundraising Workshop: Hustlin' 101

Council Chambers

Attendees will be shown how to build corporate partnerships and gain capital as well as implement fundraisers in order to fund their chapter's operations

**Facilitators: Jason Owens, Marlayna Washington**

#### Event & Conference Planning

Calmecac

This workshop will teach you what it takes to plan a successful event or conference. It will give insight on the preparation and hard work that is necessary for a successful conference/event.

**Facilitators: TBA**

#### Chapter Websites/Publicity

Quetzalcoatl B

Sending out information about your chapter to your school and community can be a difficult task. This workshop will show you how to effectively use your chapter websites and how to publicize your events in your area. It will also discuss how to use your school as a media resource.

**Facilitators: Dominique Ralph, Candace Vaughn**

#### PCI Chairs Workshop: Unlocking the Future of Our Youth

Presidential Suite

This workshop will cover the importance of this position, how to recruit PCI members and start NSBE Jr. chapters, discuss the most effective ways of recruiting and different programs that will help retain their interest and attention.

**Facilitators: Joel Townsend**



## Alumni Workshop Descriptions

#### Chapter Officer Functional Training

Backdoor

This workshop focuses on position specific training for NSBE-AE Officers. Participants will learn what is required to perform their position specific duties as well as understand how to manage NSBE within its Structure (Nationally, Regionally and Locally).

**Facilitators: RAEB**

#### Leadership Management

Backdoor

This workshop teaches a unique perspective on how leadership and time management work together. Participants will learn how self-management can directly impact overall leader effectiveness.

**Facilitators: Ann Phillips (Bio on Next Page)**

#### NSBE is only as effective as you make it!

Backdoor

This workshop focuses on elements that can make or break your NSBE Leadership experience (i.e. Membership and maintaining Gen Certification). Participants will be trained on the importance of recruiting and retaining chapter membership and participation. Additionally attendees will learn about the GEN Certification Process.

**Facilitators: Carl Conliffe & Terita Norton**

#### The More You Know...

Backdoor

This workshop focuses on Parliamentary Procedures and the Soft Skills that make managing with NSBE easier. Participants will be exposed to the soft skills, techniques, strategies, and information many ASSUME one has simply by virtue of holding a "leadership" position in NSBE. What makes an effective NSBE Leader? It takes much more than you may think. Adhering to Parliamentary Procedures during meetings makes for a more effective meeting.

**Facilitators: Ebube Akonsionu & Clayton Jordan, III**

#### Chapter Executive Board Meetings

Backdoor

This workshop focuses on chapter Executive Board interaction and dynamics. Participants will be afforded time to meet as an Executive Board to meet as individual boards to regroup and share leanings. There will be a special project during this time.

**Facilitators: RAEB**

#### Tool Time

Backdoor

This workshop focuses on review and Wrap-up of the training. Participants will be afforded time to all the tools they have acquired during the weekend. Participants will have the opportunity to ask Alumni specific to RAEB.

**Facilitators: RAEB**

